

# Guide rail brackets

## Guide rail bracket (short type)

Part. **557**

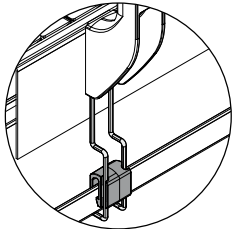

Presetting for drip tray support (see on page 31)

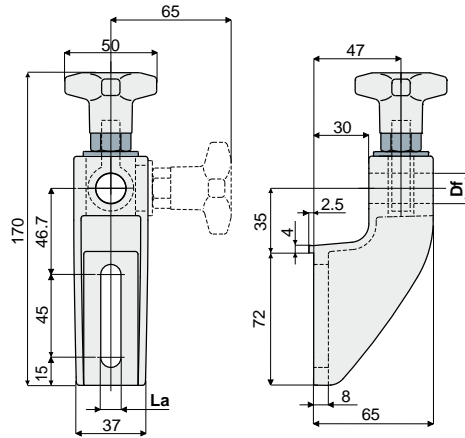

**NEW**



Df Bore for pin of (mm)	La (9 mm slot) Code
12	557 / 90803
14	557 / 90804
16	557 / 90805

**MATERIALS:** Bracket and knob made of reinforced polyamide black colour; hexagonal insert made of nickel plated brass; eyebolt, nut and washer made of stainless steel AISI 304.

**FEATURES:** Max tightening torque 4 Kg-m.

**BOX QUANTITY:** 24 pieces.

**ON REQUEST:**

- Brackets: In reinforced polypropylene, in different colours.
- Box quantity: According to your request.

## Guide rail bracket

Part. **213**

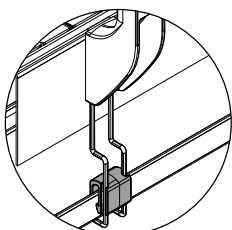

Presetting for drip tray support (see on page 31)

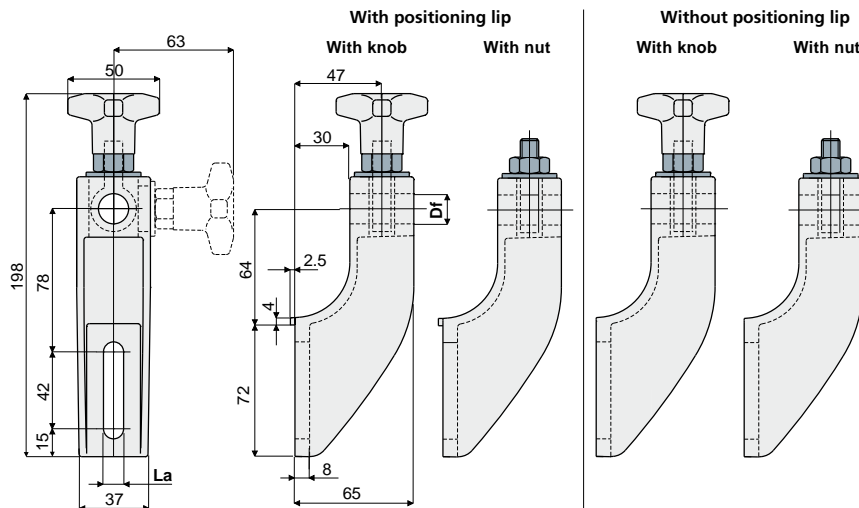

Df Bore for pin of (mm)	With positioning lip			
	La (9 mm slot)		La (11 mm slot)	
	With knob Code	With nut Code	With knob Code	With nut Code
12	213 / 81176	213 / 82105	213 / 80652	213 / 80653
14	213 / 82102	213 / 82107	213 / 80654	213 / 80655
16	213 / 82104	213 / 82109	213 / 80656	213 / 80657

Df Bore for pin of (mm)	Without positioning lip			
	La (9 mm slot)		La (11 mm slot)	
	With knob Code	With nut Code	With knob Code	With nut Code
12	213 / 86173	213 / 88826	213 / 88829	213 / 88832
14	213 / 88819	213 / 88827	213 / 88830	213 / 88833
16	213 / 88825	213 / 88828	213 / 88831	213 / 88834

**MATERIALS:** Bracket and knob made of reinforced polyamide black colour; hexagonal insert made of nickel plated brass; eyebolt, nut and washer made of stainless steel AISI 304.

**FEATURES:** Max tightening torque 4 Kg-m.

**BOX QUANTITY:** 24 pieces.

**ON REQUEST:**

- Brackets: In reinforced polypropylene, in different colours.
- Box quantity: According to your request.